



Scan for more information

PA-100

User Manual

Table of Contents

Specifications.....	3
Dimensions.....	4
Load vs Speed/Current.....	5
Feedback Options.....	6

Have any queries? Our expert engineers are here to help!



sales@progressiveautomations.com



1-800-676-6123



progressiveautomations.com

Specifications

Load (LBS)		No Load Current (A)		Full Load Current (A)		Speed (inch/sec)	
Dynamic	Static	24VDC	36VDC	24VDC	36VDC	No Load	Full Load
3,300	10,000	<1.0	<1.0	6.0	4.1	0.08	0.06

Stroke	Can customize from 4" to 45"
Protection Class	IP66M
Operational Temperature	-40°C to 70°C (-40°F to 158°F)
Noise	56 dB
Duty Cycle	12%
Limit Switch	Internal, non-adjustable
Limit Switch Feedback	Yes (Custom Order)
Feedback Options	Hall Effect (see Page 6)
Wire Length	82"
Motor Type	Brushed DC Motor
Screw Type	ACME Screw (Integrated Brake)
Housing Material	Alluminum Alloy
Gear Material	Powder Metallurgy
Rod Material	Stainless Steel
Certification	UV Ray, Salt Exposure, UL

Dimensions

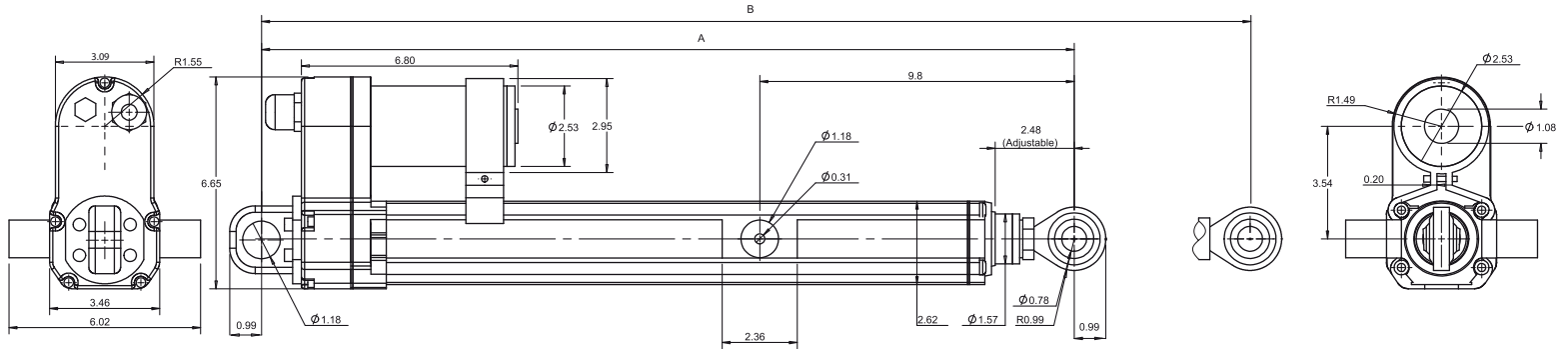
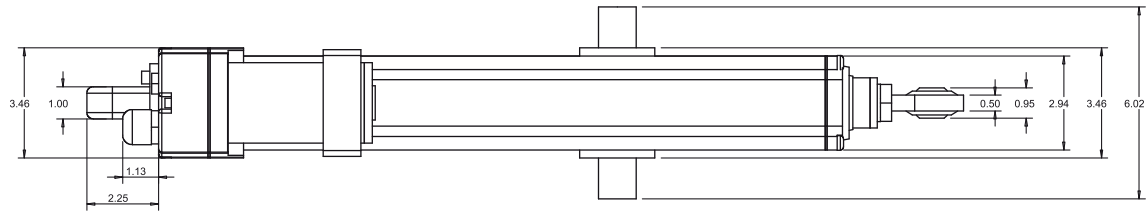

Hole to Hole

PA-100	Stroke	4	6	8	10	12	14	16	18	20	22	24	30	36	40	45
	A	17.37	19.37	21.37	23.37	25.37	27.37	29.37	31.37	33.37	35.37	37.37	46.37	52.37	56.37	61.37
B	21.37	25.37	29.37	33.37	37.37	41.37	45.37	49.37	53.37	57.37	61.37	76.37	88.37	96.37	106.37	

For Stroke Length 4" to 24"

A = Stroke Length + 13.37"

B = Stroke Length x2 + 13.37"

For Stroke Length 26" to 45"

A = Stroke Length + 16.37"

B = Stroke Length x2 + 16.37"

Load vs Speed

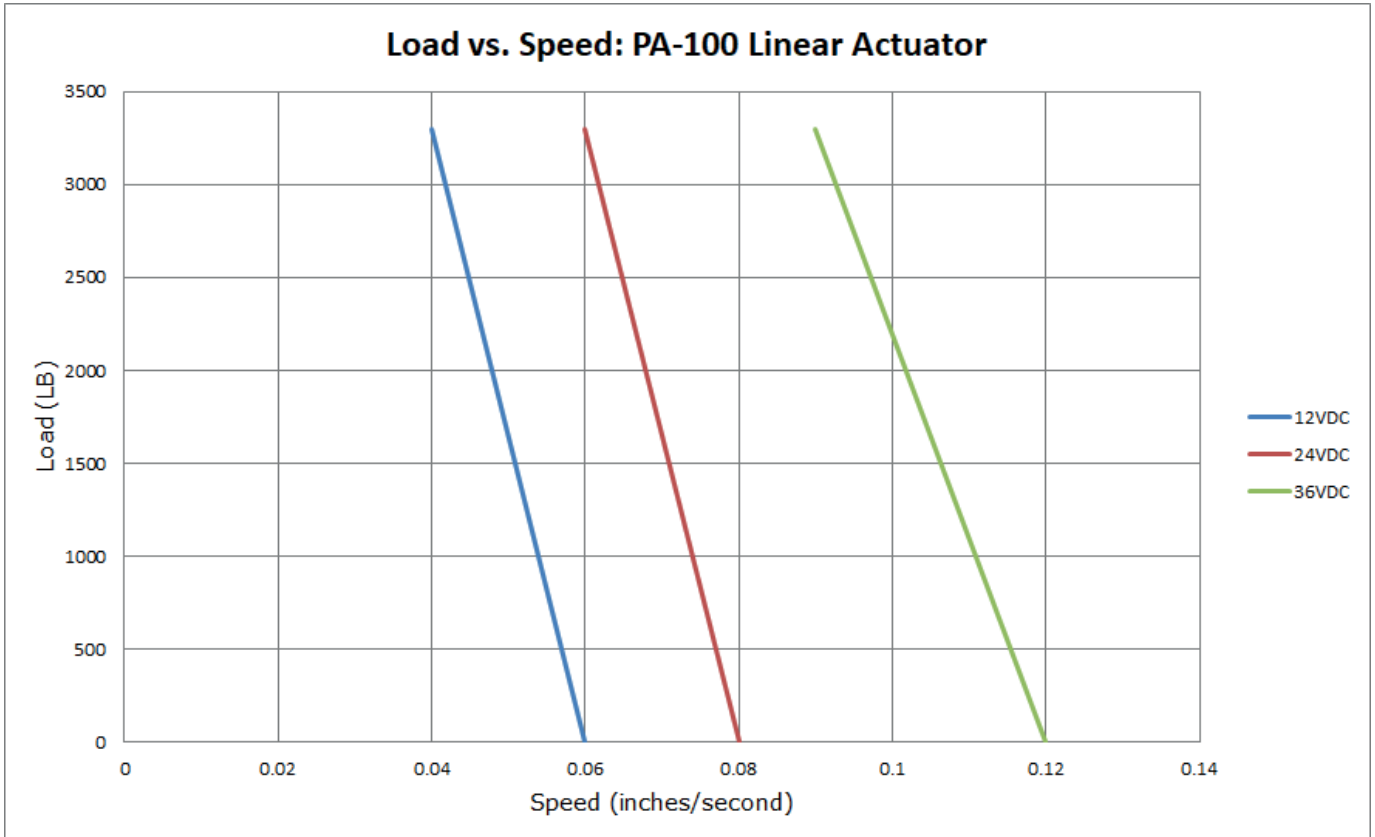

Load vs Current

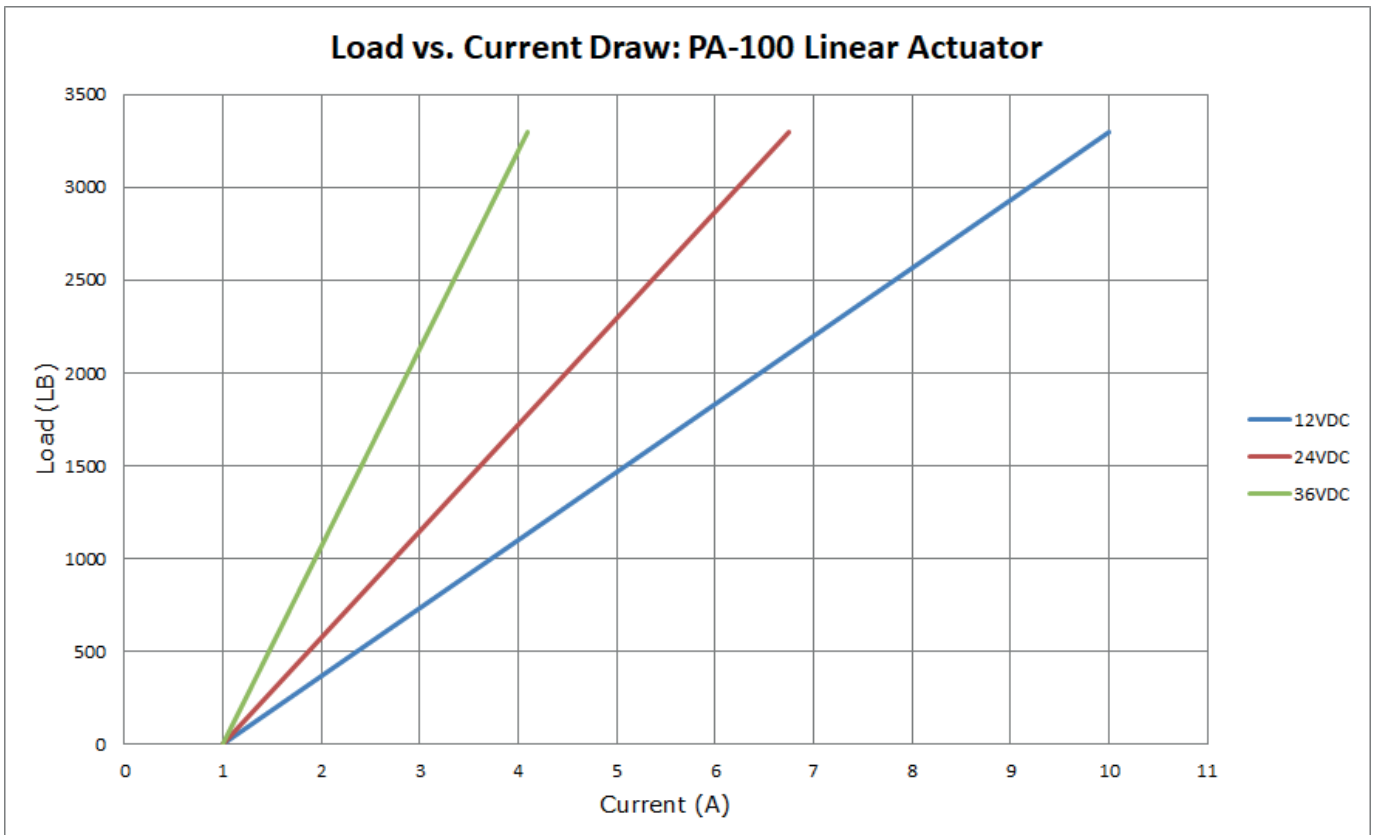

Connectors & Feedback

Pulses/inch	Resolution
2263	0.00177

6-Pin Hall Effect Connector

Front View

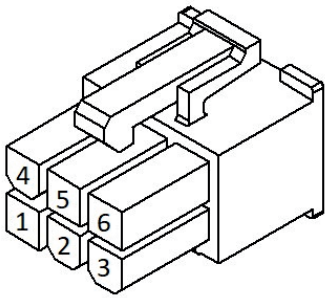

Motor		Hall Sensor			
5	4	2	3	1	6
M+ (Extend)	M- (Retract)	GND	+5VDC	Signal 2 Leads when Extending	Signal 1 Leads when Retracting

Output Signal Extending		Output Signal Retracting	
Hall Effect 1 Signal		Hall Effect 1 Signal	
Hall Effect 2 Signal		Hall Effect 2 Signal	